

FACILITIES GUIDE



 ROSEN
SHINGLE CREEK™
ORLANDO





Spaces that amaze. Service that delights. Set at the headwaters of the Florida Everglades, elevate your next meeting in a stunning 230-acre luxurious escape ranked a top 20 U.S. meeting hotel by Cvent. Rosen Shingle Creek, where every exquisite detail has been thoughtfully designed with meeting planners in mind.

Meeting & Event Space

- 490,000 sq. ft. of flexible meeting and event space
- 95,000-sq.-ft., 60,000-sq.-ft. and 40,000-sq.-ft. column-free ballrooms
- 222,000 sq. ft. of pre-function space, including outdoor terrace and event lot
- 55,000 sq. ft. of breakout space
- 17 load-in bay areas/7 roll-up doors
- 99 meeting rooms available

Guestrooms

- 1,501 elegantly appointed guestrooms and suites (436 sq. ft.)
- Complimentary Wi-Fi in guestrooms and public areas (*excludes meeting convention areas*)
- Plush Creek Sleeper mattresses, 40-inch flat-screen TVs, elegant furnishings, designer linens and makeup mirrors
- Mini-refrigerator, laptop safe, hair dryer, iron and coffee maker
- VIP Concierge Lounge

Suites & Hospitality

- 3 Presidential Suite Parlors (1,744 sq. ft.)
- 37 Grande Suite Parlors (1,308 sq. ft.)
- 69 Executive Suite Parlors (872 sq. ft.)
- 56 Petite King Suites
- 946 Double Queens
- 360 Kings
- Inclusive of 75 ADA-compliant guestrooms
- 30 Hospitality Parlors (14 - 1,308 sq. ft. and 16 - 872 sq. ft.)

Dining & Entertainment

A Land Remembered (AAA Four Diamond) – An upscale steakhouse serving Harris Ranch All-Natural Prime Black Angus Beef, Fresh Caught Florida Seafood and an impressive wine list to create sublime pairings.

Calà Bella™ (AAA Four Diamond) & Bella's Bar – Our signature fine-dining bistro is the ideal location for an excellent Italian meal.

Café Osceola & Osceola Bar – Offering the best in continental cuisine for breakfast, lunch and dinner, our daily buffets feature everything from made-to-order omelets to Filet Mignon.

Tobias Flats™ & Watering Hole – A welcoming gathering spot for hungry guests serving a diverse range of handcrafted microbrews, pub-based entrées, salads, sandwiches and soups.

Mi Casa Tequila Taquería – Home to the Jefe Margarita, where guacamole is prepared tableside, hand-crafted margaritas are plentiful and the authentic flavors are as dynamic as the atmosphere.

Banrai Sushi – Experience the harmony of subtle flavors and tantalizing textures, from traditional sushi and signature rolls to specialty sakes and inspired cocktails.

Headwaters Lounge™ – Known as the hotel's social hot spot, it's the ultimate place to network, mingle or relax with friends over a casual drink.

18 Monroe Street Market – This 24-hour deli offers a variety of deli selections with hot and cold food items available throughout the day, such as delicious soups, salads, sandwiches, pizza, fresh-baked goods and much more. Perfect for dining in or takeout. Outdoor seating available.

Shingle Creek Clubhouse Grille – Enjoy an appetizer, sandwich or lunch entrée before or after a round on our award-winning golf course.

Par-Take – Offers golfers a variety of grab-and-go snacks and drinks at the turn.

Cat-Tails Pool Bar & Grille – Choose from a selection of refreshing beverages and light menu items poolside.

Smooth Java – Perk up with freshly brewed Starbucks® or fresh-made pastries and goodies.

Creek Ice Creamery – Have a refreshing treat while enjoying the pool activities. With so many mouth-watering flavors to choose from, we're sure to have your favorite.

Room Service – 24-hour, full-service dining.

Recreation

- 4 pools including a lap pool, family pool, adult quiet pool and kiddie wading pool
- The Spa at Shingle Creek offers full-service spa, hair and nail services
- State-of-the-art fitness center with cardiovascular equipment and free weights
- 2 hot tubs
- Nature trail
- Fishing by reservation
- 2 lighted tennis courts
- Sand volleyball and basketball
- Video Arcade

Shingle Creek Golf Club

- 18-hole, par-72 (7,149-yard) championship course
- Preferred tee times for guests
- Club and golf cart rentals
- Clubhouse with entertaining areas and gift shop
- Home of the Brad Brewer Golf Academy
- Numerous distinctions including: "Top 40 Best New Golf Courses in the U.S.," *Golfweek* Brad Brewer named in the "Top 100 Instructors for 2007-2008," *Golf Magazine*

Rosen Shingle Creek

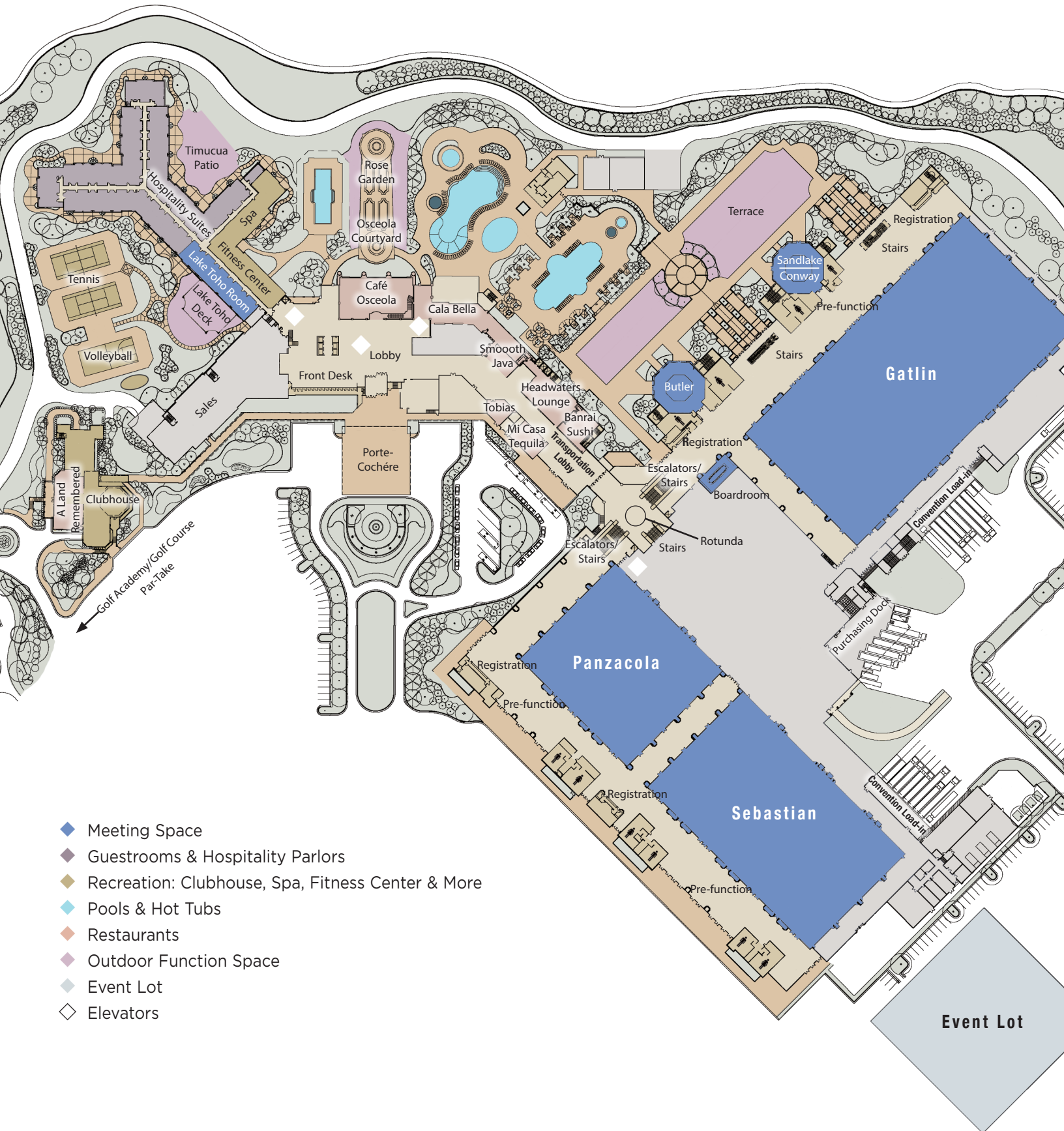

Level 1 Ballroom Capacities

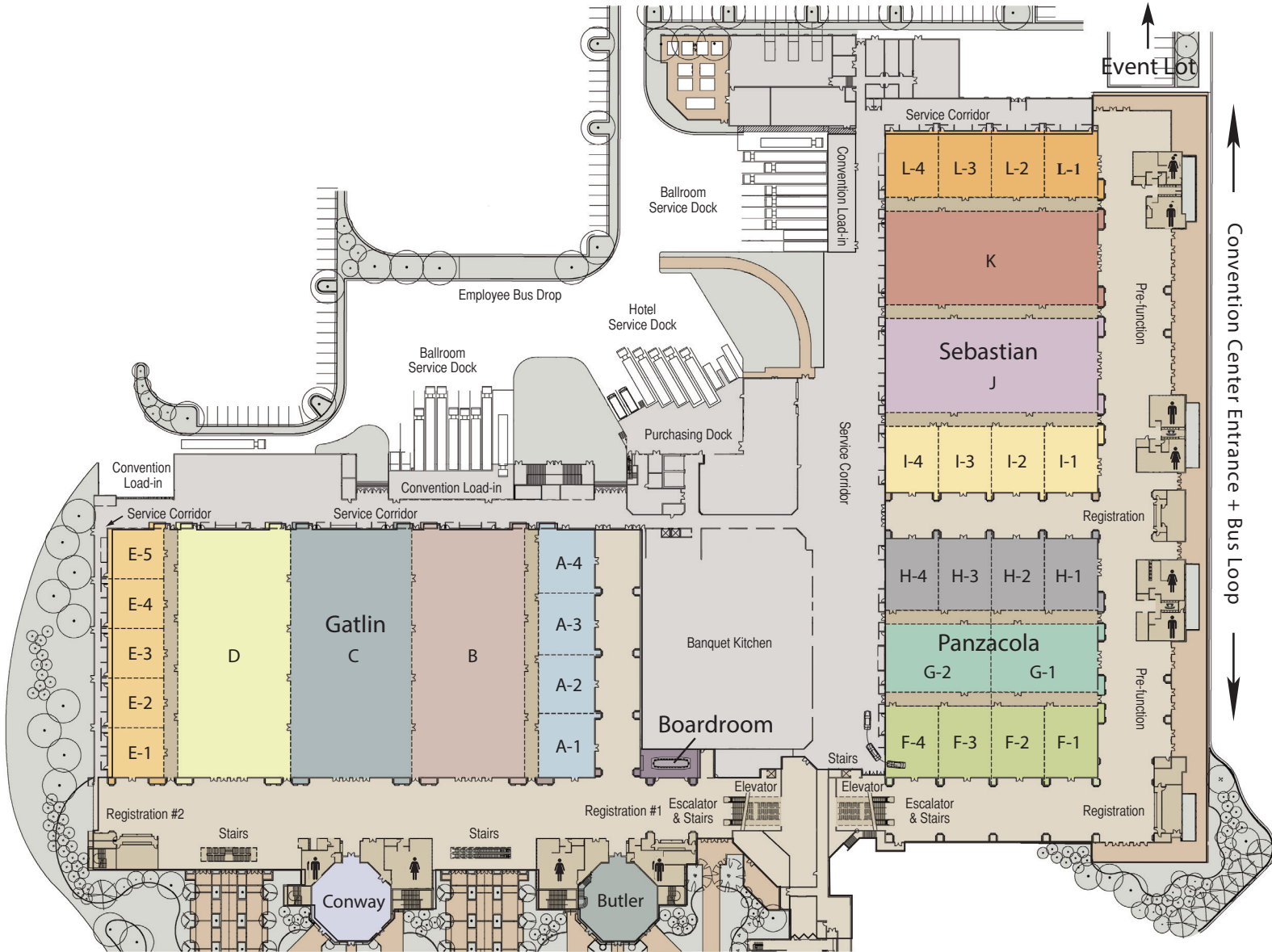

Sebastian

Notes

Event	Date/Time	Room	Sq. Ft.	Dimensions	Theatre	Schoolrm	Banquet	Reception	U-Shape	Hollow Square	8x10	10x10	Ceiling
		Sebastian	60000	319'8" x 187'6"	6000	4212	4160	6300			375	300	31'
		I	10900	58'2" x 187'6"	1090	720	760	1140			68	55	31'
		I-1	2700	58'2" x 48'6"	270	180	180	280	60	72	16	14	31'
		I-2	2700	58'2" x 48'6"	270	180	180	280	60	72	16	14	31'
		I-3	2700	58'2" x 48'6"	270	180	180	280	60	72	16	14	31'
		I-4	2700	58'2" x 48'6"	270	180	180	280	60	72	16	14	31'
		J	15500	82'10" x 187'6"	1550	1050	1010	1630			96	78	31'
		I/J	28975	153' x 187'6"	2900	1980	1920	3050			181	145	31'
		K	15500	82'10" x 187'6"	1550	1050	1010	1630			96	78	31'
		J/K	33575	176'2" x 187'6"	3350	2310	2240	3530			209	168	31'
		I/J/K	47050	250' x 187'6"	4700	3354	3310	4950			294	236	31'
		L	10900	58'2" x 187'6"	1090	720	760	1140			68	55	31'
		L-1	2700	58'2" x 48'6"	270	180	180	280	60	72	16	14	31'
		L-2	2700	58'2" x 48'6"	270	180	180	280	60	72	16	14	31'
		L-3	2700	58'2" x 48'6"	270	180	180	280	60	72	16	14	31'
		L-4	2700	58'2" x 48'6"	270	180	180	280	60	72	16	14	31'
		K/L	28975	153' x 187'6"	2900	1980	1920	3050			181	145	31'
		J/K/L	47050	250' x 187'6"	4700	3354	3310	4950			294	236	31'
		I Corridor	2575	12' x 187'6"									27'
		J/K Corridor	2575	12' x 187'6"									27'
		L Corridor	2575	12' x 187'6"									27'

Notes

Panzacola

Event	Date/Time	Room	Sq. Ft.	Dimensions	Theatre	Schoolrm	Banquet	Reception	U-Shape	Hollow Square	8x10	10x10	Ceiling
Panzacola			40000	211'2" x 187'6"	4000	2610	2570	4200			250	200	31'
F			11800	62'10" x 187'6"	1180	780	730	1200			72	60	31'
F-1			2900	62'10" x 46'6"	290	180	180	300	66	72	18	15	31'
F-2			2900	62'10" x 46'6"	290	180	180	300	66	72	18	15	31'
F-3			2900	62'10" x 46'6"	290	180	180	300	66	72	18	15	31'
F-4			2900	62'10" x 46'6"	290	180	180	300	66	72	18	15	31'
G			11250	60' x 187'6"	1125	780	730	1180			70	56	31'
G-1			5600	60' x 93'6"	560	380	360	590			35	28	31'
G-2			5600	60' x 93'6"	560	380	360	590			35	28	31'
F/G			25625	135'6" x 187'6"	2560	1700	1690	2690			160	128	31'
H			11800	62'10" x 187'6"	1180	780	730	1200			72	60	31'
H-1			2900	62'10" x 46'6"	290	180	180	300	66	72	18	15	31'
H-2			2900	62'10" x 46'6"	290	180	180	300	66	72	18	15	31'
H-3			2900	62'10" x 46'6"	290	180	180	300	66	72	18	15	31'
H-4			2900	62'10" x 46'6"	290	180	180	300	66	72	18	15	31'
G/H			25625	135'6" x 187'6"	2560	1700	1690	2690			160	128	31'
North F1/F2/G1/H1/H2			20000	211'2" x 93'8"	2000	1330	1320	2100			125	100	31'
South F3/F4/G2/H3/H4			20000	211'2" x 93'8"	2000	1330	1320	2100			125	100	31'
F1/2 G1 or F3/4 G2			12800	134' x 94'	1280	850	800	1200			80	65	31'
H1/2 G1 or H3/4 G2			12800	134' x 94'	1280	850	800	1200			80	65	31'
F/G Corridor			2251	12' x 187'6"									27'
G/H Corridor			2251	12' x 187'6"									27'

Notes

Gatlin

Event	Date/Time	Room	Sq. Ft.	Dimensions	Theatre	Schoolrm	Banquet	Reception	U-Shape	Hollow Square	8x10	10x10	Ceiling
Gatlin			95000	220' x 430'8"	9500	6432	6800	10000			594	475	31'
A			10800	220' x 49'	1080	720	720	1120			68	54	31'
A1			2685	54'8" x 49'	265	180	180	280	60	72	17	13	31'
A2			2685	54'8" x 49'	265	180	180	280	60	72	17	13	31'
A3			2685	54'8" x 49'	265	180	180	280	60	72	17	13	31'
A4			2685	54'8" x 49'	265	180	180	280	60	72	17	13	31'
B			19800	220' x 90'	1980	1365	1400	2080			124	99	31'
A/B			33440	220' x 152'	3340	2230	2390	3500			209	152	31'
C			27694	220' x 126'2"	2760	1890	1980	2900			173	138	31'
A/B/C			61134	220' x 280'	6100	4075	3400	6430			382	307	31'
B/C			47449	220' x 217'	4740	3255	3390	4990			296	237	31'
D			19800	220' x 90'	1980	1365	1400	2080			124	99	31'
A/B/C/D			81400	220' x 370'	8140	5436	5800	8565			508	407	31'
B/C/D			70180	220' x 319'	7010	4710	3840	7350			438	351	31'
C/D			47449	220' x 217'	4740	3255	3390	4990			296	237	31'
E			10780	220' x 49'	1080	720	720	1120			68	54	31'
E1			2146	43'8" x 49'	216	144	140	225	51	66	13	11	31'
E2			2146	43'8" x 49'	216	144	140	225	51	66	13	11	31'
E3			2146	43'8" x 49'	216	144	140	225	51	66	13	11	31'
E4			2146	43'8" x 49'	216	144	140	225	51	66	13	11	31'
E5			2146	43'8" x 49'	216	144	140	225	51	66	13	11	31'
D/E			33440	220' x 152'	3340	2230	2390	3500			209	152	31'
C/D/E			61134	220' x 280'	6100	4075	3400	6430			382	307	31'
B/C/D/E			81400	220' x 370'	8140	5436	5800	8565			508	407	31'
A/B Corridor			2744	220' x 12'									27'
D/E Corridor			2744	220' x 12'									27'

Notes

Pre-function

Event	Date/Time	Room	Sq. Ft.	Dimensions	Theatre	Schoolrm	Banquet	Reception	U-Shape	Hollow Square	8x10	10x10	Ceiling
Gatlin			34900					3600					
Sebastian			26600					2100					
Panzacola			26600					2800					
Panzacola East			13231					1000					
Wekiwa			5000										
Suwannee			5000										
St. John's			12875										
Mezzanine			12395										

Notes

Registration Desks/Offices

Event	Date/Time	Room	Sq. Ft.	Dimensions	Desk Length	Theatre	Schoolrm	Banquet	Reception	U-Shape	Hollow Square	Ceiling
Gatlin-1			288	12' x 24'	42'							
Gatlin-2			962	26' x 37'	40'							
Panzacola			612	12' x 51'	42'8"							
Sebastian			714	17' x 42'	38'							

Notes

Conway & Boardroom

Event	Date/Time	Room	Sq. Ft.	Dimensions	Theatre	Schoolrm	Banquet	Reception	U-Shape	Hollow Square	Conference	Ceiling
Conway			4067	70' x 70'	348	228	250	425	60	72	54	14'
Boardroom			1250	45'3" x 20'							28-30-Existing Seating	

Level 2 Meeting Room Capacities

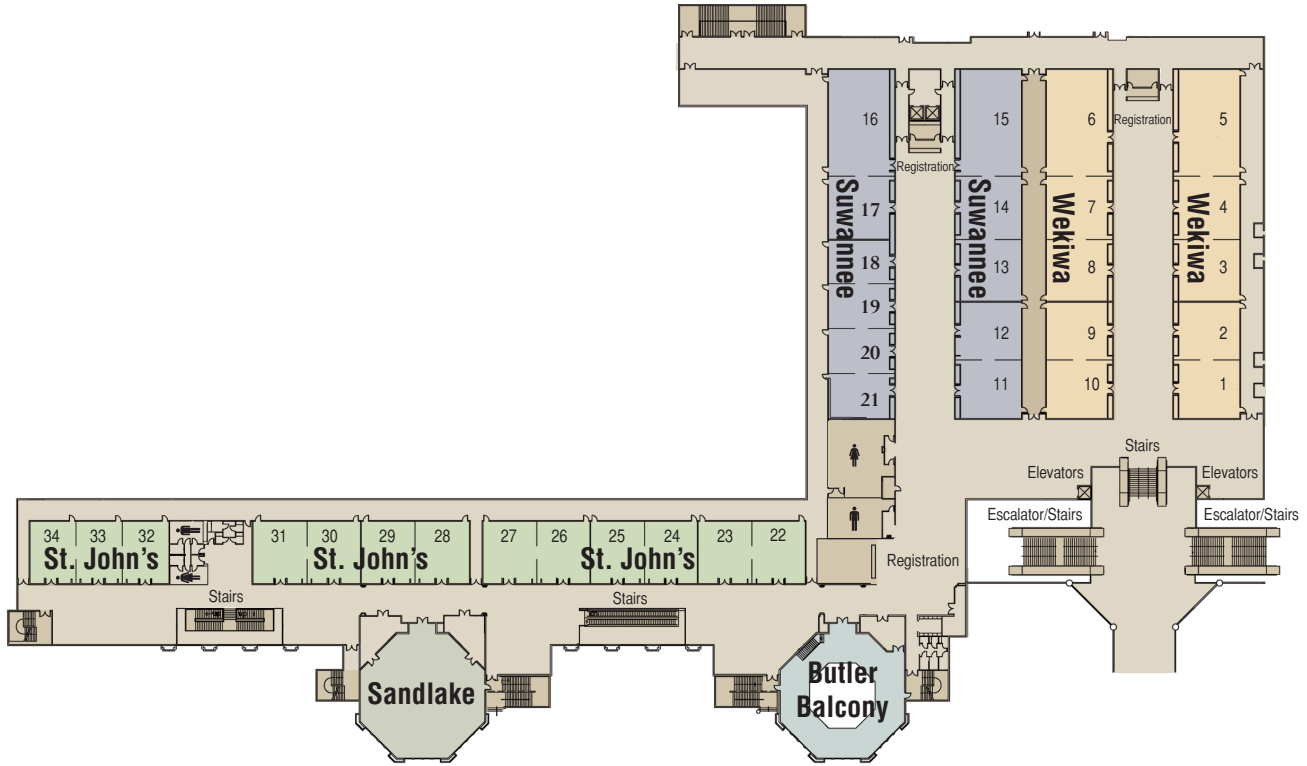

Butler & Butler Balcony

Notes

Event	Date/Time	Room	Sq. Ft.	Dimensions	Theatre	Schoolrm	Banquet	Reception	U-Shape	Hollow Square	Conference	Ceiling
		Butler Balcony*	2978	12' wide			120	150				
		Butler	4067	70' x 70'	324	204	230	350	60	72	54	14'
		Combined	7045				340	500				

Lake Toho

Notes

Event	Date/Time	Room	Sq. Ft.	Dimensions	Theatre	Schoolrm	Banquet	Reception	U-Shape	Hollow Square	Conference	Ceiling
		Lake Toho	1455	50'3" x 29'1"	130	69	90	130	18	24	42	14'

Sandlake

Notes

Event	Date/Time	Room	Sq. Ft.	Dimensions	Theatre	Schoolrm	Banquet	Reception	U-Shape	Hollow Square	Conference	Ceiling
		Sandlake	4100	70' x 70'	348	228	250	350	60	72	54	14'
		Sandlake Foyer	1848	52'8" x 35'sd								

Wekiwa

Notes

Event	Date/Time	Room	Sq. Ft.	Dimensions	Theatre	Schoolrm	Banquet	Reception	U-Shape	Hollow Square	Conference	Ceiling
		1	1100	34' x 32'8"	110	72	50	115	27	36	24	12'-14'
		2	1100	34' x 32'8"	110	72	50	115	27	36	24	12'-14'
		1/2 or 9/10	2200	34' x 66'	220	132	110	230	54	66	48	12'-14'
		3	1200	34' x 35'2"	120	72	70	125	30	42	24	12'-14'
		4	1200	34' x 35'2"	120	72	70	125	30	42	24	12'-14'
		3/4 or 7/8	2400	34' x 70'2"	240	156	150	250	66	78	54	12'-14'
		5	2000	34' x 60'	200	132	110	210	54	66	48	12'-14'
		4/5 or 6/7	3200	34' x 95'	320	204	200	335				12'-14'
		3/4/5 or 6/7/8	4400	34' x 130'5"	440	288	280	460				12'-14'
		6	2000	34' x 60'	200	132	110	210	54	66	48	12'-14'
		7	1200	34' x 35'2"	120	72	70	125	30	42	24	12'-14'
		8	1200	34' x 35'2"	120	72	70	125	30	42	24	12'-14'
		9	1100	34' x 32'8"	110	72	50	115	27	36	24	12'-14'
		10	1100	34' x 32'8"	110	72	50	115	27	36	24	12'-14'
		Mezzanine	5535									

Notes

Suwannee

Event	Date/Time	Room	Sq. Ft.	Dimensions	Theatre	Schoolrm	Banquet	Reception	U-Shape	Hollow Square	Conference	Ceiling
		11	1100	34' x 32'8"	110	72	50	115	27	36	24	12'-14'
		12	1100	34' x 32'8"	110	72	50	115	27	36	24	12'-14'
		11/12	2200	34' x 65'4"	220	132	110	230	54	66	48	12'-14'
		13	1200	34' x 35'2"	120	72	70	125	30	42	24	12'-14'
		14	1200	34' x 35'2"	120	72	70	125	30	42	24	12'-14'
		13/14	2400	34' x 70'2"	240	156	150	250	66	78	54	12'-14'
		15	2000	34' x 60'	200	132	110	210	54	66	48	12'-14'
		13/14/15	4400	34' x 130'2"	440	288	280	460				12'-14'
		16	2000	34' x 60'	200	132	110	210	54	66	48	12'-14'
		17	1200	34' x 35'2"	120	78	70	125	30	42	24	12'-14'
		14/15 or 16/17	3200	34' x 95'	320	204	200	335				12'-14'
		18	850	34' x 25'	80	33	40	85	24	30	24	12'-14'
		19	850	34' x 25'	80	33	40	85	24	30	24	12'-14'
		18/19 or 20/21	1700	34' x 50'	170	84	80	170	42	54	30	12'-14'
		20	850	34' x 25'	80	33	40	85	24	30	24	12'-14'
		21	850	34' x 25'	80	33	40	85	24	30	24	12'-14'
		18/19/20/21	3400	34' x 100'	340	204	190	350				12'-14'
		18/19/20 or 19/20/21	2550	34' x 75'	250	156	140	260	66	78	60	12'-14'

Notes

St. John's

Event	Date/Time	Room	Sq. Ft.	Dimensions	Theatre	Schoolrm	Banquet	Reception	U-Shape	Hollow Square	Conference	Ceiling
		22	1000	29'10" x 34'10"	100	60	50	105	27	30	24	12'-14'
		23	1000	29'10" x 34'10"	100	60	50	105	27	30	24	12'-14'
		22/23 or 24/25	2000	59'10" x 34'10"	200	120	110	210	51	60	52	12'-14'
		24	1000	29'10" x 34'10"	100	60	50	105	27	30	24	12'-14'
		25	1000	29'10" x 34'10"	100	60	50	105	27	30	24	12'-14'
		24/25 or 26/27	2000	59'10" x 34'10"	200	120	110	210	51	60	52	12'-14'
		26	1000	29'10" x 34'10"	100	60	50	105	27	30	24	12'-14'
		27	1000	29'10" x 34'10"	100	60	50	105	27	30	24	12'-14'
		28	1000	29'10" x 34'10"	100	60	50	105	27	30	24	12'-14'
		29	1000	29'10" x 34'10"	100	60	50	105	27	30	24	12'-14'
		28/29 or 30/31	2000	59'10" x 34'10"	200	120	110	210	51	60	52	12'-14'
		30	1000	29'10" x 34'10"	100	60	50	105	27	30	24	12'-14'
		31	1000	29'10" x 34'10"	100	60	50	105	27	30	24	12'-14'
		32	850	25'10" x 34'10"	80	30	40	85	24	30	24	12'-14'
		33	850	25'10" x 34'10"	80	30	40	85	24	30	24	12'-14'
		34	850	25'10" x 34'10"	80	30	40	85	24	30	24	12'-14'
		32/33 or 33/34	1700	51'10" x 34'10"	160	96	90	170	45	54	42	12'-14'
		32/33/34	2550	77'10" x 34'10"	240	156	140	255	69	78	66	12'-14'
		St. John's Balcony Foyer	3009	52'8" x 103"								
		St. John's North/South Foyer	1848	52'8" x 35"								

Notes

Hospitality - Meeting Parlors

Event	Date/Time	Room #	Room	Sq. Ft.
		14	Three-Bay Hospitality Parlors (at a fee)	1308 (approx.)
		16	Two-Bay Hospitality Parlors (at a fee)	872 (approx.)

*Hospitality meeting parlors will be included in the contracted guestroom block as units.

Notes

Registration Desks/Offices

Event	Date/Time	Room	Sq. Ft.	Dimensions	Desk Length	Theatre	Schoolrm	Banquet	Reception	U-Shape	Hollow Square	Ceiling
		St. John's	900	36' x 25'	27'							
		Suwannee	170	10' x 17'	17'							
		Wekiwa	170	10' x 17'	17'							

Notes

Outdoor Space

Event	Date/Time	Room	Sq. Ft.	Dimensions	Theatre	Schoolrm	Banquet	Reception	U-Shape	Hollow Square	Conference	Ceiling
		Terrace	45900		Pavers		3200	4800				
		Event Lot	39360	320' x 123'								
		Lake Toho Deck	5997		Pavers		300	500				
		Timucua Patio	10510		Pavers		700	800				
		Par-Take Golf Patio	10000									
		Butler Courtyard						150				
		Conway						150				

Ballroom Load-in Areas

Ballroom	Service Roll-Up Doors	Service Door Measurements	Load-in Bays	Drive-in Bays	Compactor Bays	Elevators Capacities
Gatlin	4 total	B - 12' w x 16' h	9	2	2	2 Freight Elevators up to 6000 lbs. each
		C - 12' w x 16' h				
		D - 12' w x 16' h				2 Service Elevators up to 4500 lbs. each
		E5 - 28' w x 16' h				
Panzacola	2 total	F & H - 12' w x 16' h				
Sebastian	4 total	I, J, K & L - 12' w x 16' h	8	1	2	

Ballroom floor loads 500 - 750 lbs. per sq. ft. Service aisles behind ballrooms are 22' wide.

Numbers shown assume maximum capacities and are subject to change upon program requirements. Ceiling heights reflect high point. Hang Points customized to your requirements. *Butler Balcony is not available for Theatre, Schoolroom or Exhibits.

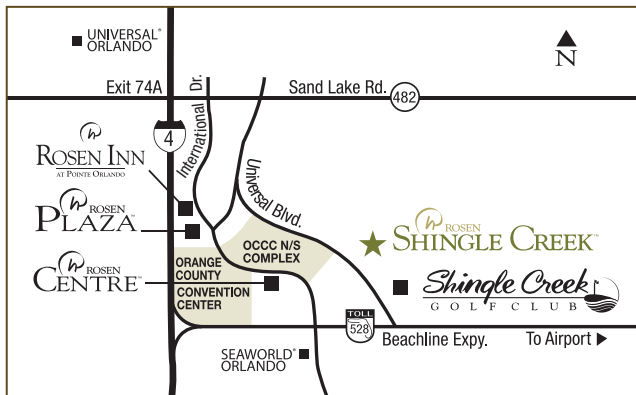

Conveniently located on Universal Boulevard, off of the Beachline Expressway (SR 528 Exit #2), one mile east of the Orange County Convention Center North/South Complex.

For photo and layout downloads, please go to our website: RosenShingleCreek.com/Press

NOTES

